

REV		DESCRIPTION	DATE	APPR
-	-	-	-	-

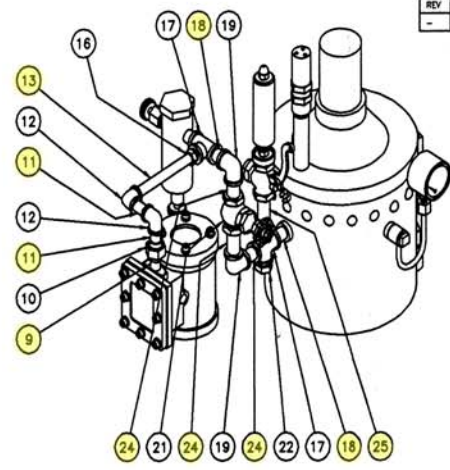

Boiler To Engine

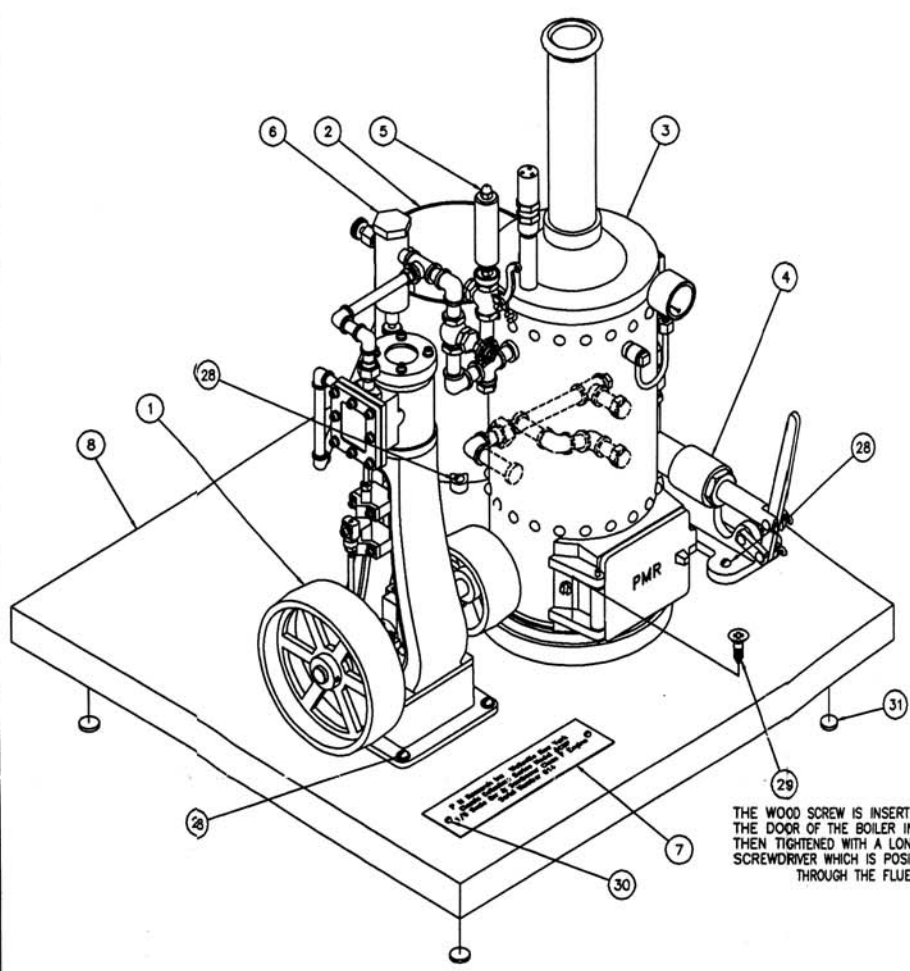
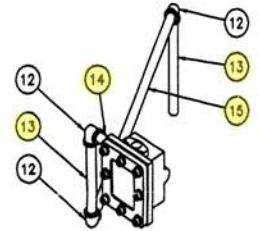

Exhaust To Tank

ASSEMBLY NOTES
 Polish all brass plumbing and parts.
 Seal all pipe joints with 'Loctite #PST 565'
 Dimensions are given for reference only.
 Mount boiler first. Install all plumbing include components but do not fasten to board.
 Correct engine for location and parallel to front edge of board. Transfer punch mounting hole locations from components to board.
 Carefully break unions and remove components from board. Drill pilot holes for wood screws to attach components. Reassemble power plant. Tighten unions first then tighten mounting screws. Add felt dots on bottom and nameplate as shown.

Orr & Sembower
 Class "F" Engine
 Model #C5P

31	4	3/8 DIA FELT DOT	STOCK
30	2	#2x1/2 SLOT RND HD BRASS WOOD SCR	STOCK
29	1	#8x1-1/4 PHIL FLAT HD Zn PL WOOD SCR	STOCK
28	12	#4x1/2 SLOT RND HD BRASS WOOD SCR	STOCK
27	2	5/16 - 1/4 REDUCER	PR5M
26	1	1/4 x 2-1/2 NIPPLE	P4M-2.5
25	3	1/4 x 1" NIPPLE	P4M-1.0
24	3	1/4 x 1/2 NIPPLE	P4M-.5
23	1	1/4 CROSS	PX4M
22	2	1/4 PIPE PLUG	PP4M
21	1	1/4 STR GLOBE VALVE	GV4M
20	1	1/4 UNION	PU4M
19	5	1/4 x 90° ELL	PL4M
18	6	1/4 CLOSE NIPPLE	PN4M
17	2	1/4 TEE	PT4M
16	1	1/4 - 3/16 REDUCER	PR4M
15	1	3/16 x 6" NIPPLE	P3M-6.0
14	1	3/16 x 1" NIPPLE	P3M-1.0
13	3	3/16 x 2" NIPPLE	P3M-2.0
12	5	3/16 x 90° ELL	PL3M
11	2	3/16 CLOSE NIPPLE	PN3M
10	1	3/16 UNION	PU3M
9	1	3/16 x 1/2 NIPPLE	P3M-.5
8	1	HARDWOOD BASE	AS-0000
7	1	NAME PLATE	AS-0000
6	1	LUBRICATOR	LUB-1M
5	1	WHISTLE	SW-4M
4	1	BOILER FEED PUMP	BFP-1M
3	1	BOILER #1	BLR-1M
2	1	WATER TANK	WTK-1M
1	1	#5 STEAM ENGINE	#5BM

Pipework Kit
 NK-C5PM
 Contents marked in yellow

QTY	PART No
3	P4M-0.5
3	P4M-1.0
1	P4M-2.5
6	PN4M
1	P3M-0.5
1	P3M-1.0
3	P3M-2.0
1	P3M-6.0
2	PN3M

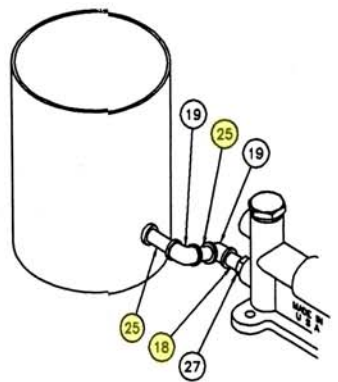

Tank To Pump

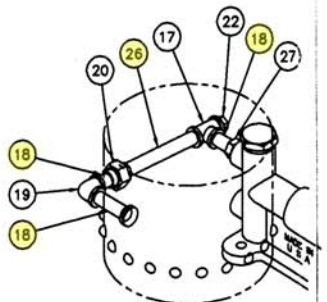

Pump To Boiler

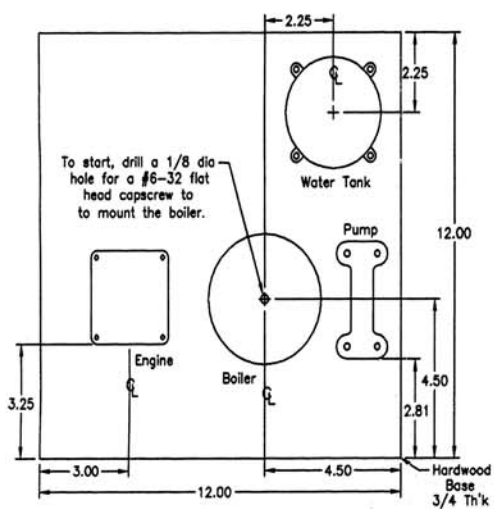

Plan View Component Layout

© COPYRIGHT
 P.M. RESEARCH INC.
 4110 NILES HILL RD.
 WELLSVILLE, N.Y. 14895

DATE 4-30-99
 SCALE NTS
 DRAWN BY PAT
 APPR BY

TITLE #CSP STEAM PLANT
 DWG NO. C-124-B

